

Motorized Screws

8MS00

- Manual drive with a dial knob
- Resolution 0.156 μm (1/8 step)
- Scale on the dial knob allows reading accuracy to a step

- Two limit switches
- Optional power supplies for higher voltages/ speeds are available

Motorized Screws

8MS00-10-28

8MS00-25-28



8MS00-10-28

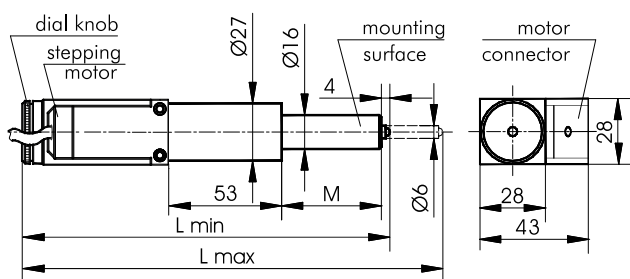

SPECIFICATIONS

Travel range	8MS00-10-28	10 mm
	8MS00-25-28	25 mm
Lead screw pitch		0.25 mm
Resolution in full step		1.25 μm
Nominal force		80 N
Cable		integrated, 1.6 m length
Motor connector		HDB15(M)
Stepper motor		28
Weight	8MS00-10-28	0.45 kg
	8MS00-25-28	0.5 kg

Model	M, mm	L min, mm	L max, mm
8MS00-10-28	37	157.5	167.5
8MS00-25-28	47	167.5	192.5

Motorized Screws

8MS00-10

8MS00-25



8MS00-10

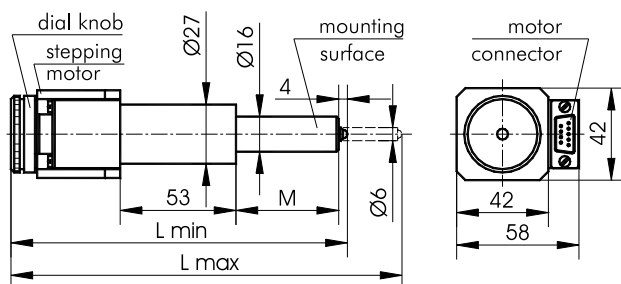

SPECIFICATIONS

Travel range	8MS00-10	10 mm
	8MS00-25	25 mm
Lead screw pitch		0.25 mm
Resolution in full step		1.25 μm
Nominal force		60 N
Motor connector		DB9(M)
Stepper motor		4233
Weight	8MS00-10	0.5 kg
	8MS00-25	0.55 kg

Model	M, mm	L min, mm	L max, mm
8MS00-10	37	143.5	153.5
8MS00-25	47	153.5	178.5

Motorized Screws

8MS00V-10

8MS00V-25



8MS00V-10

SPECIFICATIONS

Travel range	8MS00V-10	10 mm
	8MS00V-25	25 mm
Lead screw pitch		0.25 mm
Resolution in full step		1.25 μm
Nominal force		30 N
Fluoroplastic cable		integrated, 2 m length
Motor connector		HDB15(M)
Stepper motor		VSS43
Weight	8MS00V-10	0.55 kg
	8MS00V-25	0.6 kg

Motorized Actuators

8CMA06

8CMA06-13/15

- Compact
- Manual drive with a knob
- Limit switch: optoelectronic couple
- Step motor controllers are offered separately
- Optional power supplies for higher voltages/speeds are available

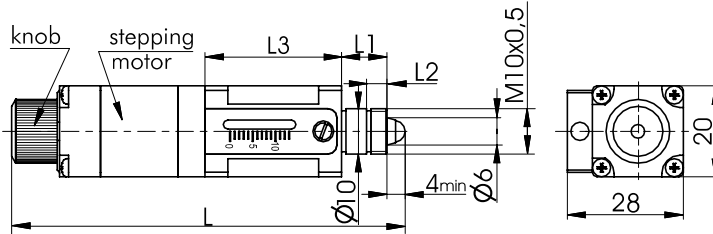
SPECIFICATIONS

Travel range	8CMA06-13/15	13 mm
	8CMA06-25/15	25 mm
Resolution		1.25 μ m
Lead screw pitch		0.25 mm
Nominal force		30 N
Cable	integrated, 1.2 m length	
Motor connector	HDB15(M)	
Stepper motor	20	
Weight	8CMA06-13/15	0.12 kg
	8CMA06-25/15	0.15 kg

Model	L, mm	L1, mm	L2, mm	L3, mm
8CMA06-13/15	92...105	15	7	30
8CMA06-25/15	101...126	15	7	40

nut 3N10X05 (M10x0.5) by request (see page 8-48)

Available Travel Range of 13 mm and 25 mm Motorized Actuators with DC MOTOR (see on the next page)

8MT184-13

Translation stage 7T184-13
with motorized actuator
8CMA06-13/15 with
stepper motor
Resolution 1.25 μ m

page 8-52

Modified Manual Stages with Motorized Actuators are available

8MT184-13DC

Translation stage 7T184-13
with motorized actuator
8CMA06DC-13/15 with DC motor
Minimum Incremental Motion
0.028 μ m

page 8-53

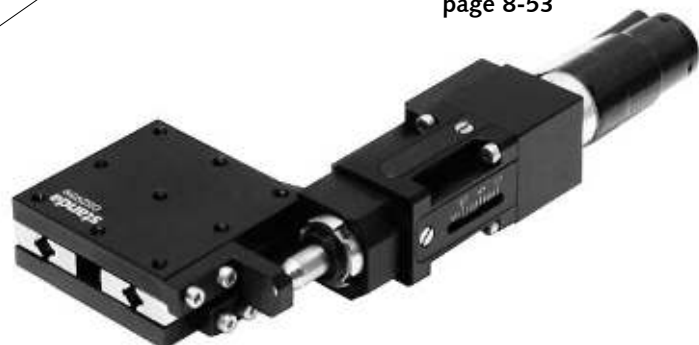

www.standa.it

e-mail: sales@standa.it



Phone: +370-5-2651483

Fax: +370-5-2651474

standa

 Optical
Tables

 1
Brackets
& Rails

 2
Base
Mounts &
Accessories

 3
Optical
Mounts

 4
Optical
Positioners

 5
Base
Positioners

 6
Translation &
Rotation
Stages

 7
Motorised
Positioners &
Controllers

 8
Fine
Adjustment
Screws

 9
Opto-
Mechanics &
Sets

 10
Light Test &
Measurements

 11
Lasers &
Accessories

12

Ultra-High Resolution Compact Motorized Actuator with DC motor

8CMA16DC



8CMA16DC-13/15

SPECIFICATIONS

Travel range	8CMA16DC-13/15	13 mm
	8CMA16DC-25/15	25 mm
Resolution		0.1 μm
Minimal incremental motion		0.028 μm
Lead screw pitch		0.25 mm
Max.speed		0.15 mm/s
Nominal force		30 N
Cable		integrated, 1.2 m length
Motor connector		IDC-10F
DC motor		DCE1524
Weight	8CMA16DC-13/15	0.12 kg
	8CMA16DC-25/15	0.15 kg

Recommended controller for DC Motor

Stepper, BLDC and DC Motor Controller with USB Interface



8SMC4-USB-B8-1
1 axis Controller in box

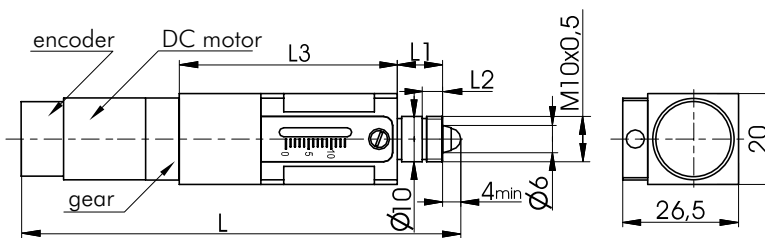

Model	L, mm	L1, mm	L2, mm	L3, mm
8CMA16DC-13/15	109.5...122.5	15	7	50
8CMA16DC-25/15	119.5...144.5	15	7	60

Ultra-High Resolution Compact Motorized Actuator with Vacuum compatible DC motor

8CMA16DCV



8CMA16DC-25/15

SPECIFICATIONS

Travel range	8CMA16DCV-13/15	13 mm
	8CMA16DCV-25/15	25 mm
Resolution		0.1 μm
Minimal incremental motion		0.028 μm
Lead screw pitch		0.25 mm
Max.speed		0.15 mm/s
Nominal force		30 N
Cable		integrated, 2 m length
Motor connector		IDC-10F
Vacuum compatible DC motor		DCE1841
Weight	8CMA16DCV-13/15	0.12 kg
	8CMA16DCV-25/15	0.15 kg

Compatible with 10⁻⁶ Torr vacuum

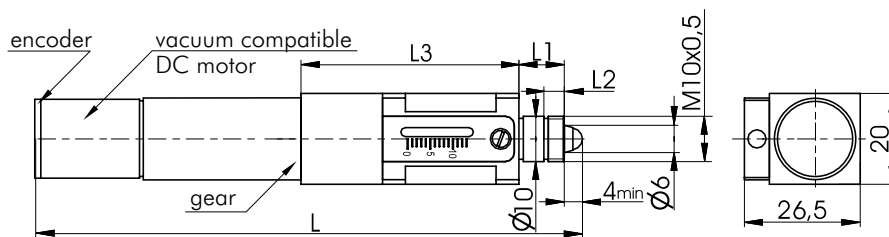

Model	L, mm	L1, mm	L2, mm	L3, mm
8CMA16DCV-13/15	125...138	15	7	50
8CMA16DCV-25/15	135...160	15	7	60

Compact Motorized Actuator

8CMA20-8/15



8CMA20-8/15

- Reduced size
- Manual drive with a knob
- Limit switch: optoelectronic couple
- Step motor controllers are offered separately
- Optional power supplies for higher voltages/speeds are available

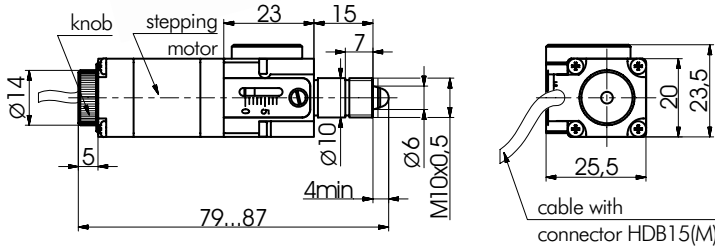

SPECIFICATIONS

Travel range	8 mm
Resolution	1.25 µm
Lead screw pitch	0.25 mm
Nominal force	30 N
Cable	integrated, 1.2 m length
Motor connector	HDB15(M)
Stepper motor	20
Weight	0.10 kg

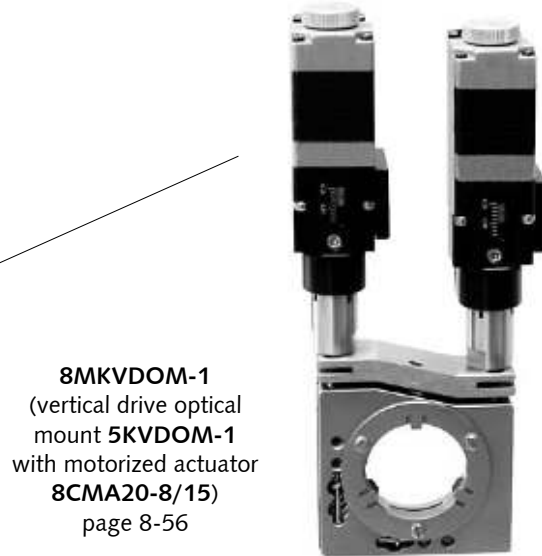
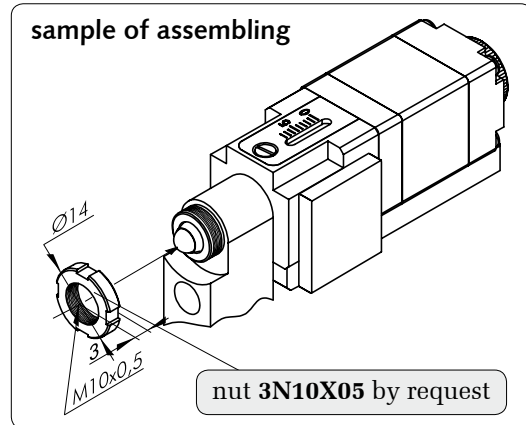

Available Motorized Actuator with 10⁻⁶ Torr VACUUM compatible DC MOTOR
8CMA20DCV-8/15

Available Motorized Actuator with DC MOTOR
8CMA20DC-8/15

- Optical Tables 1
- Brackets & Rails 2
- Base Mounts & Accessories 3
- Optical Mounts 4
- Optical Positioners 5
- Base Positioners 6
- Translation & Rotation Stages 7
- Motorised Positioners & Controllers 8
- Fine Adjustment Screws 9
- Opto-Mechanics & Sets 10
- Light Test & Measurement Instruments 11
- Lasers & Accessories 12

www.standa.it
e-mail: sales@standa.it
Phone: +370-5-2651474 Fax: +370-5-2651483

Motorized Actuator

8CMA28-10



- Compact
- Manual drive with a knob
- Two limit switches
- Step motor controllers are offered separately
- Optional power supplies for higher voltages/speeds are available

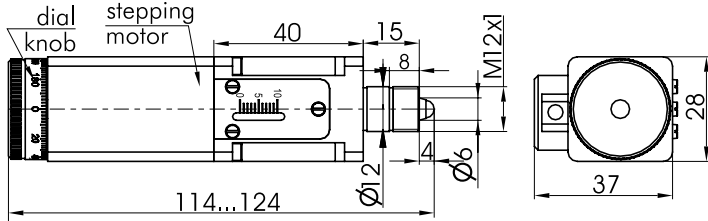

SPECIFICATIONS

Travel range	10 mm
Resolution	1.25 μ m
Lead screw pitch	0.25 mm
Nominal force	70 N
Cable	integrated, 1.2 m length
Motor connector	HDB15(M)
Stepper motor	28
Weight	0.15 kg

Related Controllers

8SMC4-USB-B8-1
1 axis Controller in box

more info on www.standa.it

- 1 Optical Tables
- 2 Brackets & Rails
- 3 Base Mounts & Accessories
- 4 Optical Mounts
- 5 Optical Positioners
- 6 Base Positioners
- 7 Translation & Rotation Stages
- 8 Motorised Positioners & Controllers
- 9 Fine Adjustment Screws
- 10 Opto-Mechanics & Sets
- 11 Light Test & Measurement Instruments
- 12 Lasers & Laser Accessories



8MBM57-6
(mirror/beamsplitter mount **5BM57-6** with motorized actuator **8CMA28-10**)



8MR128
(micro rotation stage **7R128** with motorized actuator **8CMA06-13/10**)



8MR170-190
(rotation stage **7R170-190** with motorized actuator **8CMA28-10**)

Modified Manual Stages with Motorized Actuators are available



e-mail: sales@standa.it

www.standa.it



Phone: +370-5-2651474

Fax: +370-5-2651483



standa

